



Quick Start Guide

Orb Outdoor 2



Know Your Orb Outdoor 2

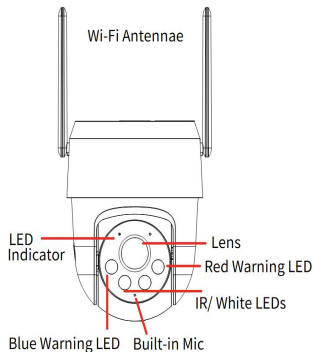

LED Indicator Status:

- Flashing Green: Hotspot Enabled
- Flashing Red: WiFi disconnected
- Solid Green: Booting Up/ Online
- Solid Red: Undergoing Reset

Package Contents

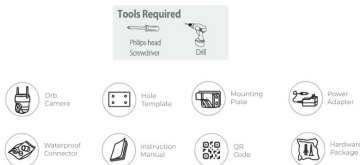

Installation

Step 1 Mark the Mounting Holes. Use the included template to mark the screw holes and drill them. Install Wall Anchor if installing on stucco, brick, or concrete. For wood, drywall or soft surface, skip this step.

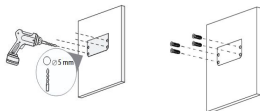

Step 2 Install the Mount. Using a Phillips-head screwdriver and the included screws, install the base as shown below (ceiling or wall mounted).

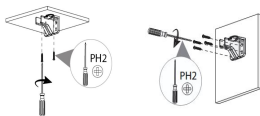

Step 3 Install the Camera Body to the Mount. Slide the camera onto the Mount. The Base tab will click, indicating the camera has seated properly on the mount.

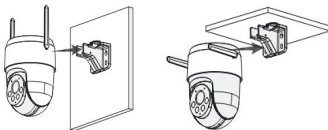

Step 4 Connect the Wires.

Connect the included power supply and (if not using WiFi), connect an ethernet cable. See below. **Note that the Camera does not support PoE.**



Step 5 (Optional) Install the SD Card. Remove the cover panel using a Phillips-head screwdriver to access the SD card slot. The Reset button will be located here as well.

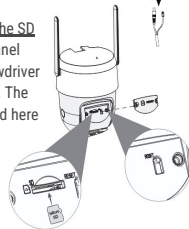

Step 6 (Optional) Waterproof the cabling. Use electrical tape or approved outdoor adhesive to cover the Power cable. For Ethernet cable, use included connector cover. See below.

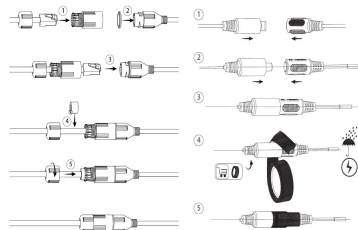

Using IC View Pro

1 Power on the Orb Outdoor 2 camera and download the IC View Pro App from Google Play or Apple App Store.



2 Open the App, and register a new account.

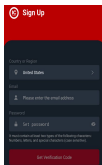

3 On the device page of the app press the "+" icon to initiate QR code scanning.

4 Scan the QR code on the back of the Orb Outdoor 2. You can also manually enter the serial number on the following page.

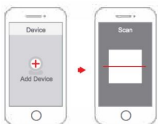

5 Tap "Next" if you should see a flashing green light on the front of the camera that indicates the hotspot is active (If not, press the reset button on the device).

6 Connect your mobile device to the Orb Outdoor 2's hotspot. The Wi-Fi name will appear as the *OrbOutdoor2-device serial number*.

7 Choose a password for your Orb Outdoor 2, then follow the in-app instructions.



8 Login to the local Wi-Fi network. Then, create a device name and set the time zone.

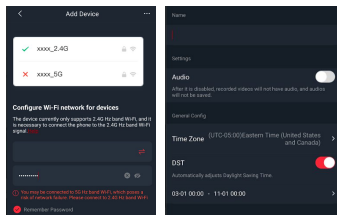

Illumination Modes

The Orb outdoor has 3 illumination modes. These can be changed by going to the IC View Pro app, selecting the camera and tapping on **Device Details > More > Illumination settings**.

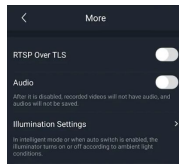

Intelligent Mode: IR is on by default, but when a target is detected, the white LEDs turn on for a full-color night image.

White Light Mode (default): White LEDs are used for night illumination. Provides full color image at night.

IR mode: IR LEDs are used for night illumination. Provides a black and white image at night.

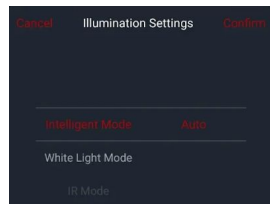

Frequently Asked Questions

Does the Orb Outdoor 2 support 5GHz Wi-Fi?

Yes. It works with both 2.4GHz and 5GHz Wi-Fi networks.

Why isn't the video camera turning on?

- Make sure the camera is using the supplied power supply and that it is connected properly.
- This camera does not support PoE power so it will need a power supply even if plugged into a PoE source.

How do I reset the Orb Outdoor 2?

Open the Reset/Micro SD card slot cover on the back of the lens body.

While powered, press and hold the **RESET** button. Release it when you hear the audio prompt/chime. After a minute, a slow green light will show the camera is ready to set up.

Why can't I connect the Orb outdoor to Wi-Fi?

Wait for the camera to flash a slow green light. Then go to your phone's Settings > Wi-Fi and connect to the "OrbOutdoor2_xxx" hotspot.

Why is the camera offline?

Check if the LED is solid green.

- If **yes**, check if your Wi-Fi router is online.
- If **no**, factory reset the camera and reconnect. Make sure the Wi-Fi signal is strong.

Why can't I connect to the device hotspot?

Make sure the IC View Pro app has Location and Wi-Fi permissions.

If your phone doesn't connect automatically, go to Wi-Fi settings and connect to the hotspot manually. Stay connected to the hotspot during setup.